

# Hour Meters

## Type series HK 17



### General Description:

7-digit resp. 8-digit hour meter for AC or DC voltage.

No reset

Display: 99999,99 h with AC  
999999,99 h with DC

Frequency standard: 50 or 60 Hz with AC  
quarz with DC

Drive: synchronous motor at AC  
Schrittmotor bei DC

4 different front bezels

Electrical connection through screw terminals. (If the screws and the terminals are removed the counter offers a flat pin connection of 0.8 x 6.3 mm.)

Counter with protected screw terminals (ref. to options) have a longer housing (total length = 68.6 mm).

### Technical data:

Optical size of digits: 3.8 x 1.7 mm

Display:

Hours: white digits on black

Decimals: red digits on black

Mounting position: variable

Voltages: 20–30, 42–48, 100–130, 187–264, 360–440 VAC  
50 or 60 Hz  
10–30, 36–80, 100–130 VDC

Normal voltage: 230 VAC

Special voltages: on request

Power consumption:

approx. 500 mW at 10–30 VDC

approx. 900 mW at 36–80 VDC

approx. 750 mW at 100–130 VDC

approx. 0.3 VA 20–30 VAC, 50 Hz

approx. 0.25 VA at 42–48 VAC, 50 Hz

approx. 0.6 VA at 100–130 VAC, 50 Hz

approx. 1.2 VA at 187–264 VAC, 50 Hz

approx. 1.65 VA at 360–440 VAC, 50 Hz

Termination:

Flat pins 0.8 x 6.3 mm with screw terminal  
or flat pins 0.8 x 6.3 mm only

Operation indicator:

AC: fast rotation wheel with red stripes

DC: 1/100 h-display rotates every 36 seconds by 1 number

Test voltage: 2000 VAC, 50 Hz

Permissible ambient temperature:

-15°C...+50°C

Protective system:

IP 52 (frontside and built-in)

Colour of housing:

black (standard)

Weight: approx. 40 g

Front panels/frames:

0 = no front frame (panel only)

(durchgehendes Gehäuse)

1 = large front frame for screw mounting

2 = small front frame with spring clip

4 = front frame with lateral mounting holes

Type of housing:

5 = housing grey or black with pressed-in magnifying lens

0 = clear housing with moulded magnifying lens and black mask

Size of housing:

1 = short housing, 55.8 mm long with non-protected terminal,

3 = large housing, 68.6 mm long with protected terminal

Termination:

11 = flat pins 0.8 x 6.3 mm

39 = screw terminal with flat pins  
0,8 x 6,3 mm

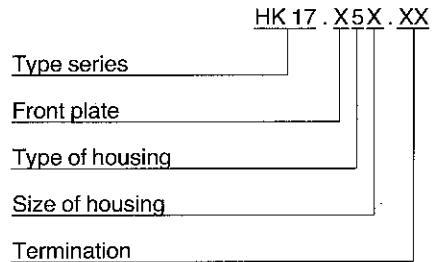

Order Information: Art.-No.

### Options:

1. colour of housing: grey  
Art.-No. 3.130.X50.XXX

2. counter with flat pins 0.8 x 6.3 mm  
Art.-No.3.138.X51.XXX

VDE-approved, cRU

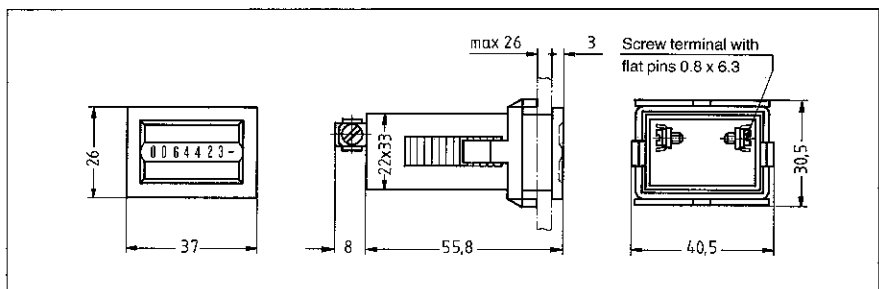
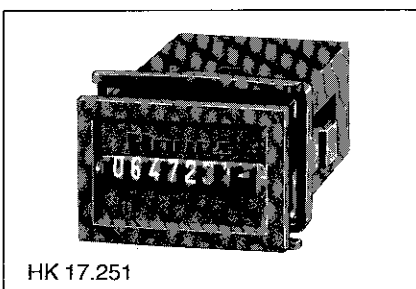

Voltage	Article No. (AC), 50 Hz	Article No. (AC), 60 Hz	Article No. (VDC)
10–30			3.130.251.351
20–30	3.130.251.071	3.130.251.081	
36–80			3.130.251.353
42–48	3.130.251.072	3.130.251.082	
100–130	3.130.251.074	3.130.251.084	3.130.251.381
187–264	3.130.251.075	3.130.251.085	
360–440	3.130.251.079	3.130.251.089	

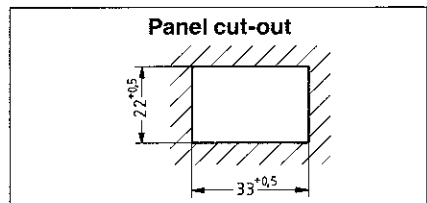

Colour of housing grey: Art.-No. 3.130.250.XXX

# Hour Meters

Type series HK 17

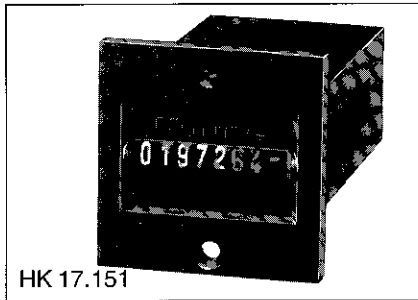

HK 17.151

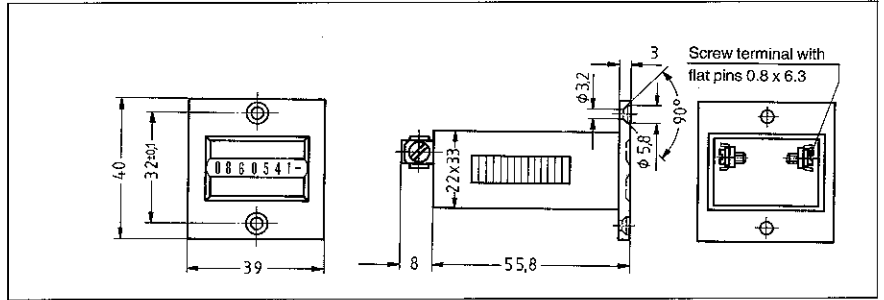

Voltage	Article No. (AC), 50 Hz	Article No. (AC), 60 Hz	Article No. (VDC)
10-30			3.130.151.351
20-30	3.130.151.071	3.130.151.081	
36-80			3.130.151.353
42-48	3.130.151.072	3.130.151.082	
100-130	3.130.151.074	3.130.151.084	3.130.151.381
187-264	3.130.151.075	3.130.151.085	
360-440	3.130.151.079	3.130.151.089	

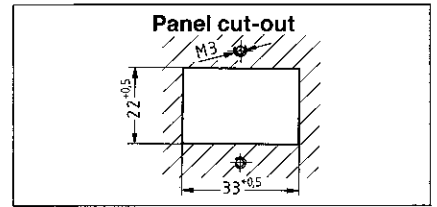

Colour of housing grey: Art.-No. 3.130.150.XXX

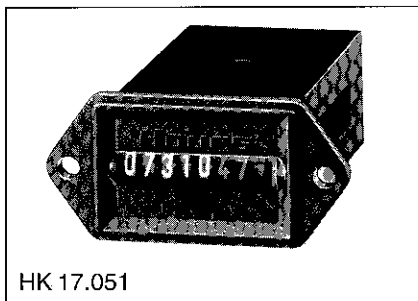

HK 17.051

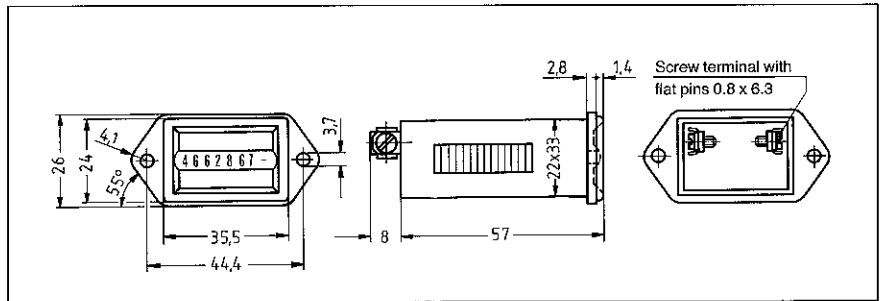

Voltage	Article No. (AC), 50 Hz	Article No. (AC), 60 Hz	Article No. (VDC)
10-30			3.130.451.351
20-30	3.130.451.071	3.130.451.081	
36-80			3.130.451.353
42-48	3.130.451.072	3.130.451.082	
100-130	3.130.451.074	3.130.451.084	3.130.451.381
187-264	3.130.451.075	3.130.451.085	
360-440	3.130.451.079	3.130.451.089	

Colour of housing grey: Art.-No. 3.130.450.XXX

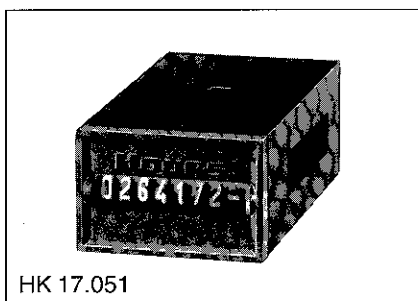

HK 17.051

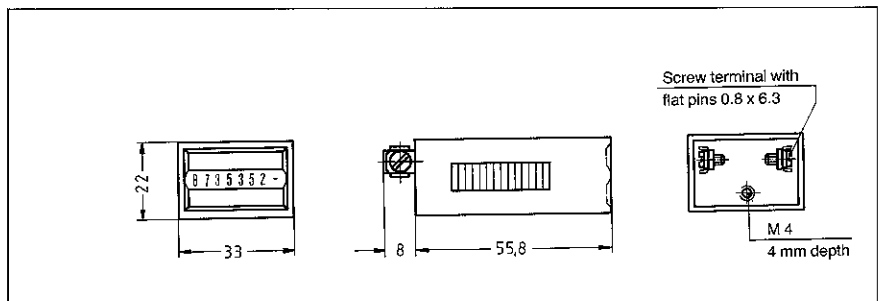

Voltage	Article No. (AC), 50 Hz	Article No. (AC), 60 Hz	Article No. (VDC)
10-30			3.130.051.351
20-30	3.130.051.071	3.130.051.081	
36-80			3.130.051.353
42-48	3.130.051.072	3.130.051.082	
100-130	3.130.051.074	3.130.051.084	3.130.051.381
187-264	3.130.051.075	3.130.051.085	
360-440	3.130.051.079	3.130.051.089	

Colour of housing grey: Art.-No. 3.130.050.XXX

# Hour Meters

Type series HK 17

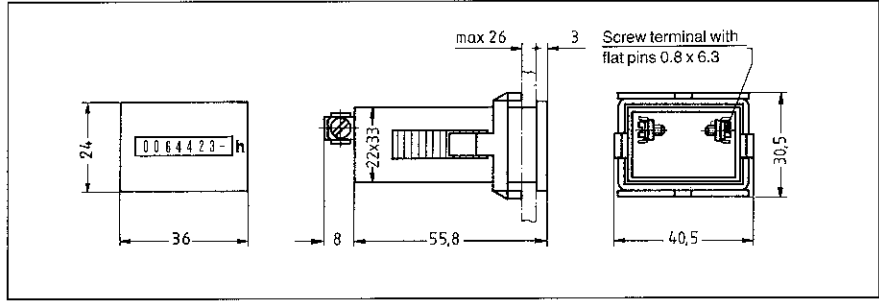
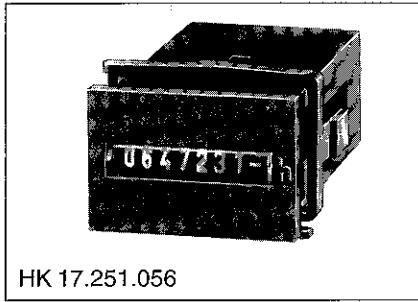

Voltage	Article No. (AC), 50 Hz	Article No. (AC), 60 Hz	Article No. (VDC)
10-30			3.130.251.351.056
20-30	3.130.251.071.056	3.130.251.081.056	
36-80			3.130.251.353.056
42-48	3.130.251.072.056	3.130.251.082.056	
100-130	3.130.251.074.056	3.130.251.084.056	3.130.251.381.056
187-264	3.130.251.075.056	3.130.251.085.056	
360-440	3.130.251.079.056	3.130.251.089.056	

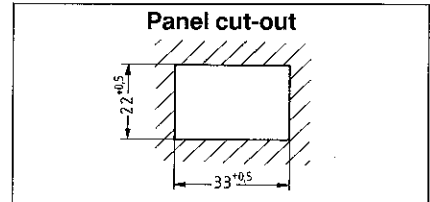

Colour of housing grey: Art.-No. 3.130.250.XXX.056